

1 Remove the circular rose cover plate and slide the plate carefully off the handle - ensuring not to damage the lever finish in the process. You now will be able to view the fixing holes.

2 Locate spindle in one lever ensuring, if applicable that the spindle groove is aligned with the grub screw hole in the lever shank.

3 Insert spindle through lock/latch follower ensuring that lever is the correct way up in respect of design and spring action, so that the inner rose is flat against the face of the door.

Once lever is suitably aligned secure it in place with the grub screw provided, ensure there is sufficient spindle projection so it can be located in the other handle.

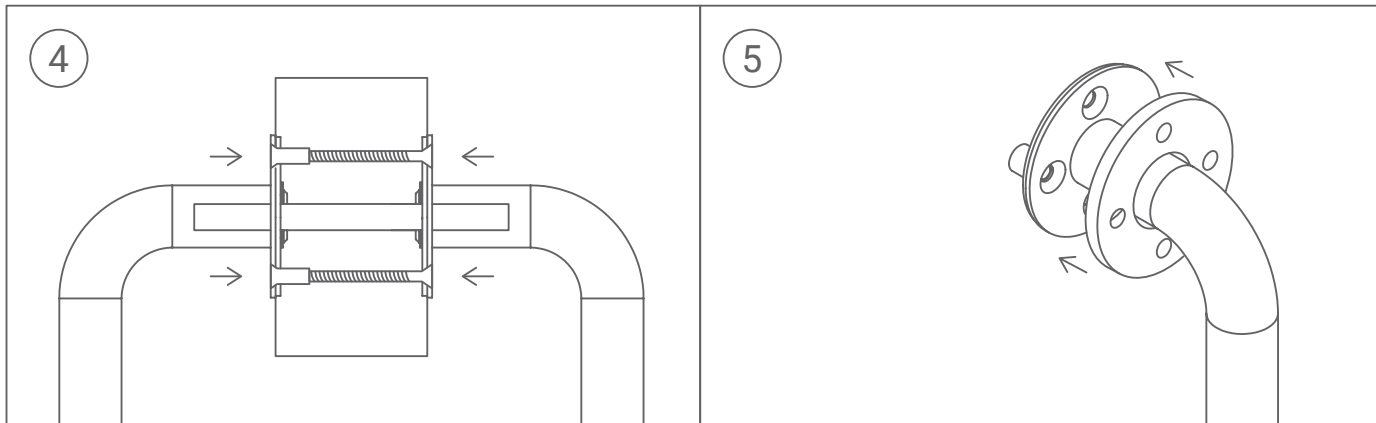

4 Insert male bolts through inner rose so they locate cleanly with female bolt from the other side. Tighten bolts ensuring threads do not cross.

5 Replace the rose cover

Glossary of terms

Spindle:

A spindle is a rod of metal, square in section, that is used to connect two door knobs together.

Rose:

This is a circular plate on which the handle or knob are mounted.

Grub screw:

A small screw used to secure an object against or within another object.